

# INSTALLING FORTIFIBER® HOUSEWRAPS

## INCLUDING WEATHERSMART® & PLYDRY®

Fortifiber Building Systems Group® provides this guide to assist builders by demonstrating an efficient and effective method for installing Fortifiber's housewraps in residential and light commercial buildings. The back of this document has details integrating housewrap with window flashing.

Compliance with the local building code and proper installation are critical in reducing potential water intrusion. It is the responsibility of the architect or builder to ensure that these standards are met.

Fortifiber housewraps are available in a variety of widths and lengths to meet your needs. The following Fortifiber Building Systems Group products are needed for a quality installation:

- **Fortifiber Sheathing Tape**  
1.875" x 165' rolls
- **Moistop® Sealant (Exceeds AAMA Standards)**
- **Any Fortifiber Window Flashing Product**

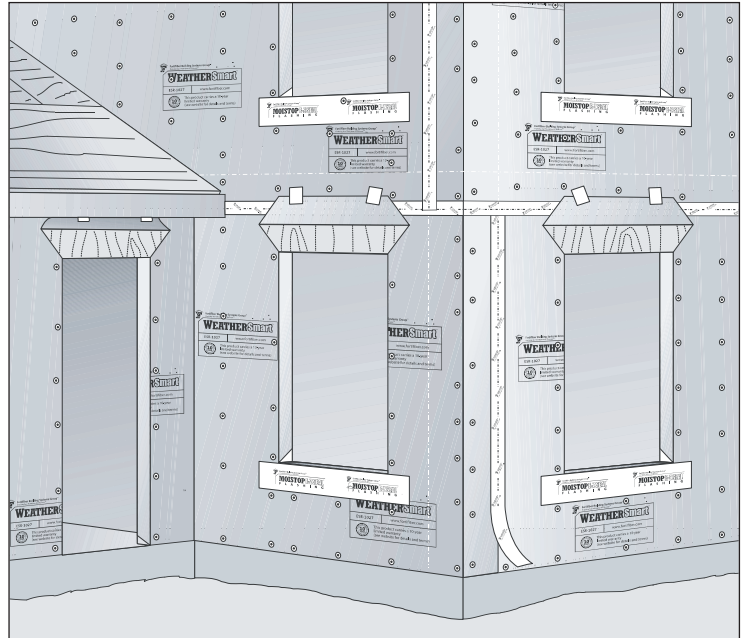

## 1 INSTALLING HOUSEWRAP

Install housewrap over an approved exterior sheathing. Starting at the bottom of one end of the wall, place the housewrap roll horizontally and roll out the first course evenly, covering rough window and door openings. When starting at a corner, overlap by a minimum of 12". Attach the membrane so that it is tight and flat. Fasten housewrap securely to the exterior wall with appropriate fasteners (Step 2).

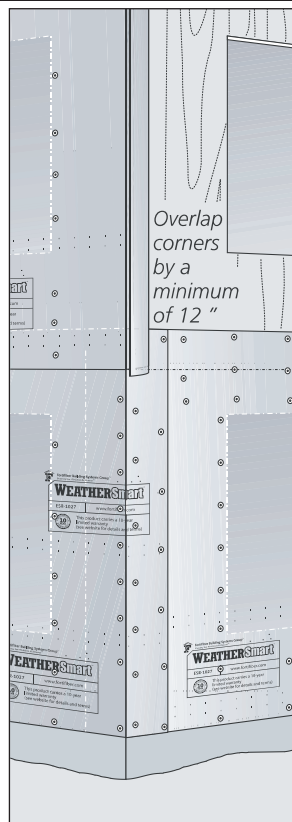

## 2 FASTENING

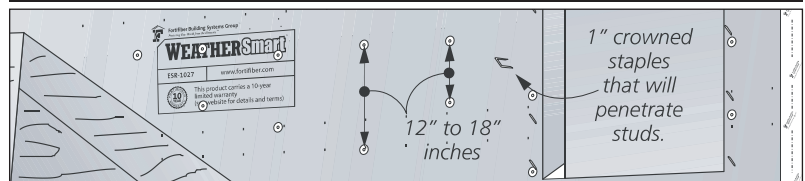

Fortifiber recommends using a minimum 1" plastic cap fasteners (minimum 1" staples that penetrate the studs are acceptable) to attach housewrap so that it is taut and flat. The proper spacing for these fasteners is 12" to 18" on center. Guide marks have been printed every 8" to help locate studs.

## 3 OVERLAP AND TAPE SEAM

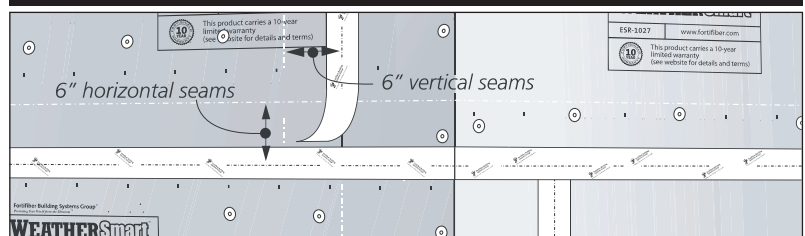

At vertical seams, apply a minimum of 6" vertical overlap. When going around corners, make sure housewrap is pulled tightly and properly fastened. Any succeeding course should be placed horizontally over the lower course in a weather-board fashion with a minimum horizontal overlap of 6". It is recommended to tape all vertical seams with **Fortifiber Sheathing Tape**; all seams must be taped to achieve an air barrier install; consult your design professional where necessary.

# HOUSEWRAP AND WINDOW FLASHING

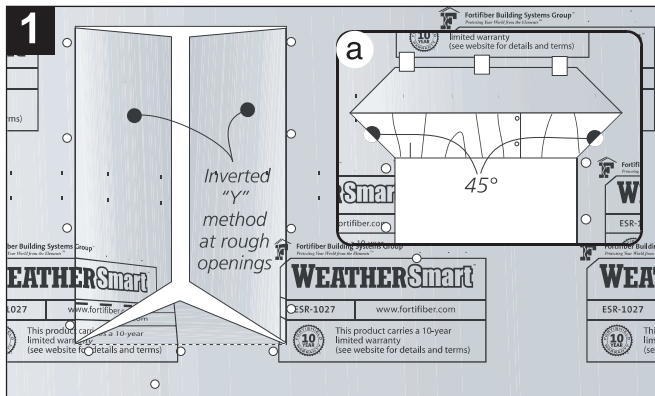

At the rough opening, cut housewrap in an inverted "Y" fashion, and then fasten with the methods described in **Step 2**. To allow for head flashing integration, make a 45° cut in housewrap as shown above in **detail a**. Ensure that any protrusions in the wall assembly including windows, doors, vents, hose bibs and electrical boxes are flashed and integrated properly into housewrap.

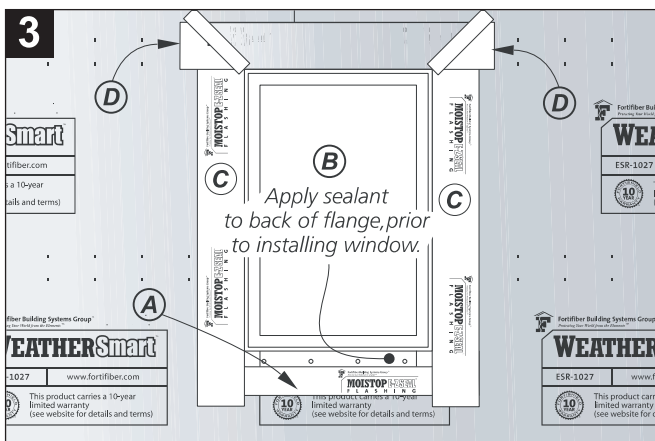
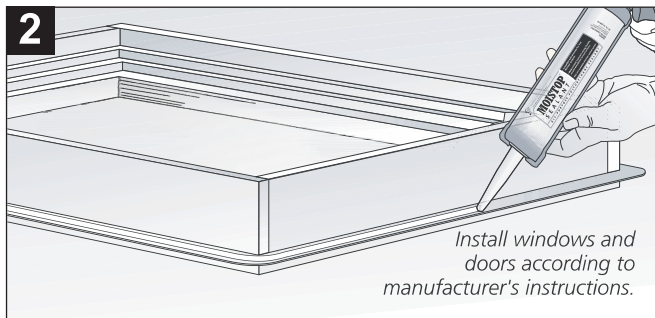

To integrate windows and doors properly into housewrap, follow these steps: **A)** Install the window flashing on the sill flush with the rough opening. **B)** Apply a 3/8" bead of **Moistop Sealant** to the back side of the window flange and secure the window in place. **C)** After the window is set, apply flashing to both jambs. **D)** Install the head flashing and re-integrate the head flap with **Fortifiber Sheathing Tape**.

At [Fortifiber.com](http://Fortifiber.com) you can find other detailed instructions on how to integrate weather-resistive barriers and window flashings. Listed below are some of the situations that you'll encounter when installing housewrap. For detailed instructions on each of these methods, visit our web site at [www.fortifiber.com](http://www.fortifiber.com)

## WHEN HOUSEWRAP IS INSTALLED BEFORE THE WINDOW:

Use the following guide  
**Method A1 (self adhesive)**

## WHEN HOUSEWRAP IS INSTALLED AFTER THE WINDOW:

Use one of the following guides that apply.  
**Method A (self adhesive)**  
**Method B (mechanically attached)**  
**High Performance System**

## HOUSEWRAP AND SPECIALTY WINDOWS:

Use one of the following guides that apply.  
**Window and Door Flashing**  
(Installing Wood Windows and Doors with integral brick mold)  
**Arched Window Flashing**

**\*Note:** Always consult local building codes and window manufacturer's instructions for flashing details. The schematic on this page is method "A1" for self-adhesive flashing. For details concerning this flashing method and alternate flashing methods please call (800) 773-4777 or visit [www.fortifiber.com](http://www.fortifiber.com). Direct exposure of sealant to the adhesive side of **FortiFlash**® can be detrimental if the amount of sealant exceeds what is specified. Please follow these recommendations regarding location and amount of sealant to be used. Fortifiber strongly recommends against the practice of using a "knockdown bead of sealant" or "buttering the flange" with sealant, because this amount of sealant is excessive and unnecessary.

**Limitations:** Fortifiber housewrap should be covered within 120 days. Inspect product to insure it is free of any protrusions or damage which may detract from the weather-resistive barrier integrity. Holes, tears or punctures should be sealed with **Moistop Sealant** or **Fortifiber Sheathing Tape**. This product is not recommended for horizontal, roofing or below grade applications. Fortifiber strongly recommends the use of a **Two-Ply Jumbo Tex** product or two layers of a single **Jumbo Tex** product when used with a three-coat stucco system. Ensure that a layer of **Super Jumbo Tex 60 minute** is used to separate housewrap and Portland cement stucco or mortar used in masonry veneer walls.



Protecting Your World from the Elements®

NATIONAL SALES OFFICE - Fernley, NV

(7/17/13)

Call 1-800-773-4777 Nationwide for Technical Assistance or visit our Web site at [www.fortifiber.com](http://www.fortifiber.com)