

INDIANAPOLIS MILLWORK CATALOG



U.S. L U M B E R

an **S B P** brand

DEDICATED TO MOULDING

ABOUT U.S. LUMBER

For more than 30 years, U.S. LUMBER has worked to build a business designed around the needs of building materials dealers. In that time U.S. LUMBER has grown geographically. We have added distribution brands like **Alexandria Moulding** and **USL Direct**, expanded our product and service offering, and remained committed to meeting a standard of trust and responsiveness that is unmatched in the industry. Today our company serves over 15,000 customer locations in the United States and Canada with more than 50 categories of unique specialty building products.



U.S. LUMBER is a “values” based organization, governed by a culture of respect, honoring people first, and operating according to a true moral compass aimed at doing what is right. U.S. LUMBER diligently extends that circle to each of our employees, our customers, our suppliers and everyone that we encounter in the business.



U.S. LUMBER
is working tirelessly to
be an essential part of
your business.

COMMITMENT TO MILLWORK

U.S. LUMBER can proudly point to the millwork segment as a cornerstone of our business. The combination of U.S. Lumber, Alexandria Moulding and USL Direct makes U.S. LUMBER one of the largest distributors of Moulding and Millwork in North America with a total millwork inventory that exceeds any competitor. Now, with 4 Alexandria Moulding manufacturing locations we also have the assurance of continued supply and the opportunity to deliver made to order product solutions. With the addition of USL Direct, we can also offer direct and reload options for high volume buyers of commodities such as manufacturers, door shops, and consolidated dealers. U.S. LUMBER is positioned to effectively address every need in the market for moulding products.



OUR PEOPLE

Our buyers, sellers and Millwork Managers are dedicated, career, millwork professionals. Buyers are working to consolidate our purchases and coordinate them with the largest manufacturers in the world to bring to market the highest quality products at the most competitive pricing. Millwork Salespeople and Millwork Managers work locally in each market to keep a clear focus on the individual product and service needs of customers in each region. With over 5000 different items in stock, our branch inventories are finely tuned with the right mix of profiles, substrates and finishes to meet the unique architectural and traditional applications for the area. These dedicated millwork professionals are the best and most local resource for technical and market information.

CEILING

CROWN/BED

04

DOOR & WINDOW

CASING

09

BRICK MOULD & STOP

13

JAMBS & STOOL

14

FLOOR

BASE

15

BASE CAP, BASE SHOE & QUARTER ROUND

16

WALL

CHAIR RAIL & PANEL MOULD

22

S4S

S4S BOARDS/ S4S STOCKS & SQUARE

23

PATTERN STOCK

24

GENERAL PURPOSE

HAND RAIL

25

CEILING - CROWN/BED

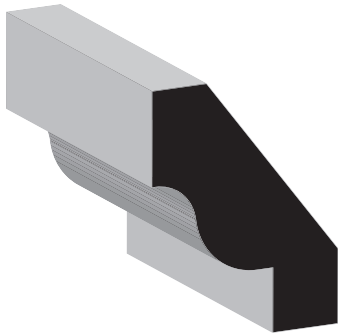

| SKU | Crown/Bed | |
|--|--|--------|
| 60 | 9/16" X 1-3/4" | Primed |
| $w \begin{array}{ c} \hline c \\ \hline \end{array}$ | Primed Wall: 1-5/16" & Ceiling 1-13/16" | |

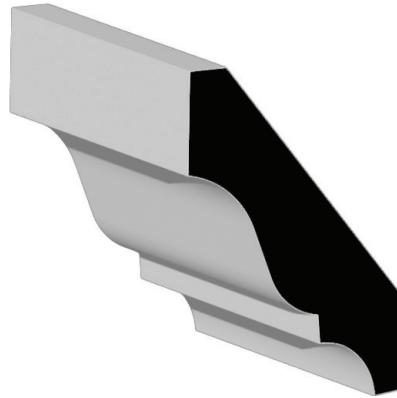

| SKU | Crown/Bed | |
|--|--|--------|
| 54 | 9/16" X 2-1/4" | Primed |
| $w \begin{array}{ c} \hline c \\ \hline \end{array}$ | Primed Wall: 1-13/16" & Ceiling 1-5/16" | |

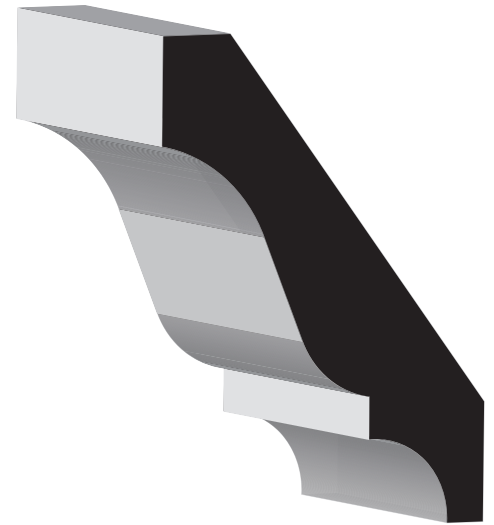

| SKU | Crown/Bed | |
|--|---|------------|
| 51 | 5/8" X 3-1/4" | Clear, MDF |
| $w \begin{array}{ c} \hline c \\ \hline \end{array}$ | Clear, MDF Wall: 2-5/8" & Ceiling 1-7/8" | |

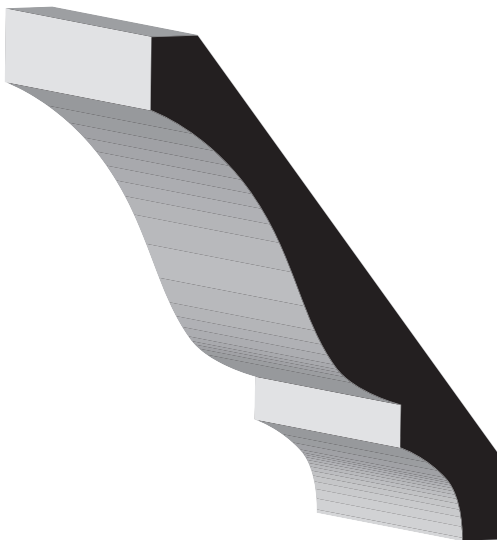

| SKU | Crown/Bed | |
|--|--|------------|
| 45 | 1/2" X 3-5/8" | Clear, MDF |
| $w \begin{array}{ c} \hline c \\ \hline \end{array}$ | Clear, MDF Wall: 3-13/16" & Ceiling: 2-3/4" | |

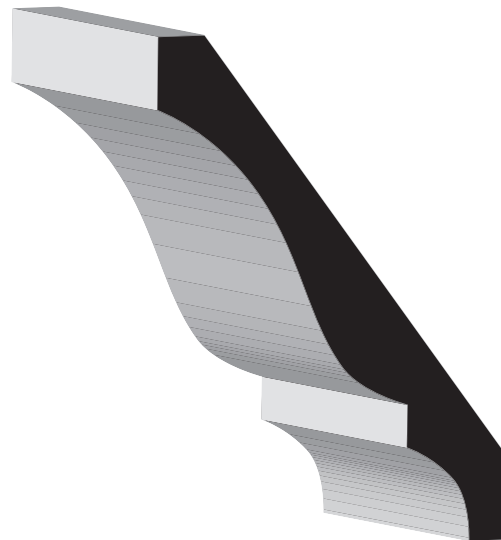

| SKU | Crown/Bed | |
|--|--|--------|
| 48 | 9/16" X 4-1/4" | Primed |
| $w \begin{array}{ c} \hline c \\ \hline \end{array}$ | Primed Wall: 3-5/16" & Ceiling 2-5/8" | |

CEILING - CROWN/BED

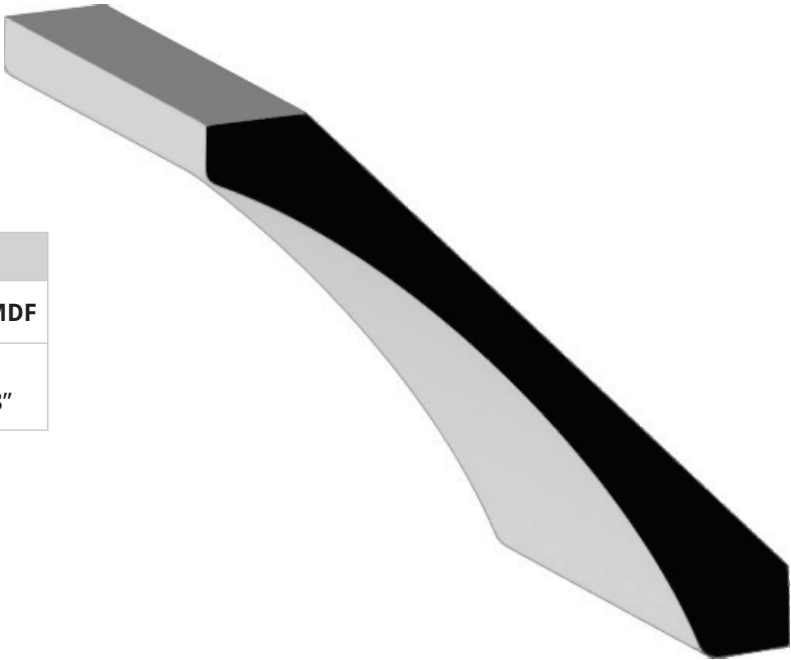

| SKU | Crown/Bed | |
|-----|--|-------------|
| 519 | 9/16" X 4-1/4" | Primed, MDF |
| | Primed Wall: 3-5/16" & Ceiling 2-5/8" | |

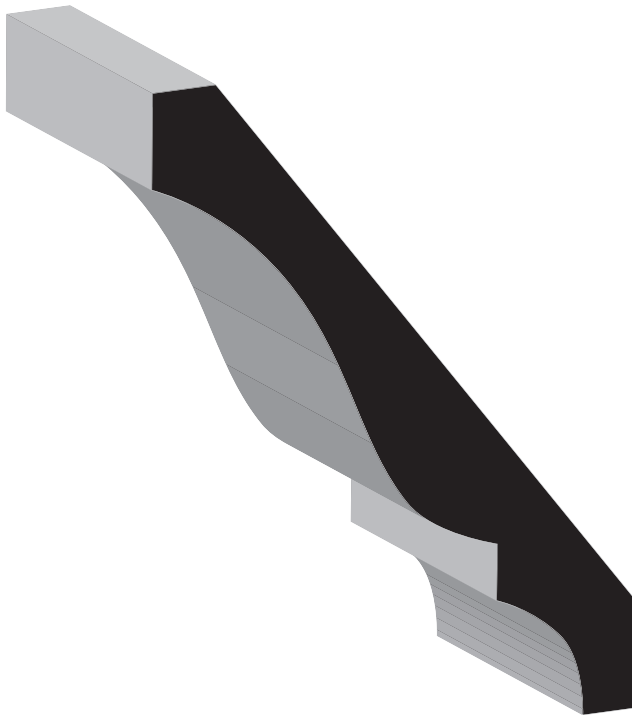

| SKU | Crown/Bed | |
|-----|--|--------|
| 47 | 9/16" X 4-5/8" | Primed |
| | Primed Wall: 3-1/4" & Ceiling: 3-1/4" | |

CEILING - CROWN/BED

| SKU | Crown/Bed | |
|---|---|-------------|
| 653 | 11/16" X 5-1/4" | Primed, MDF |
|  | Primed Wall: 4-1/16" & Ceiling: 3-15/16" | |

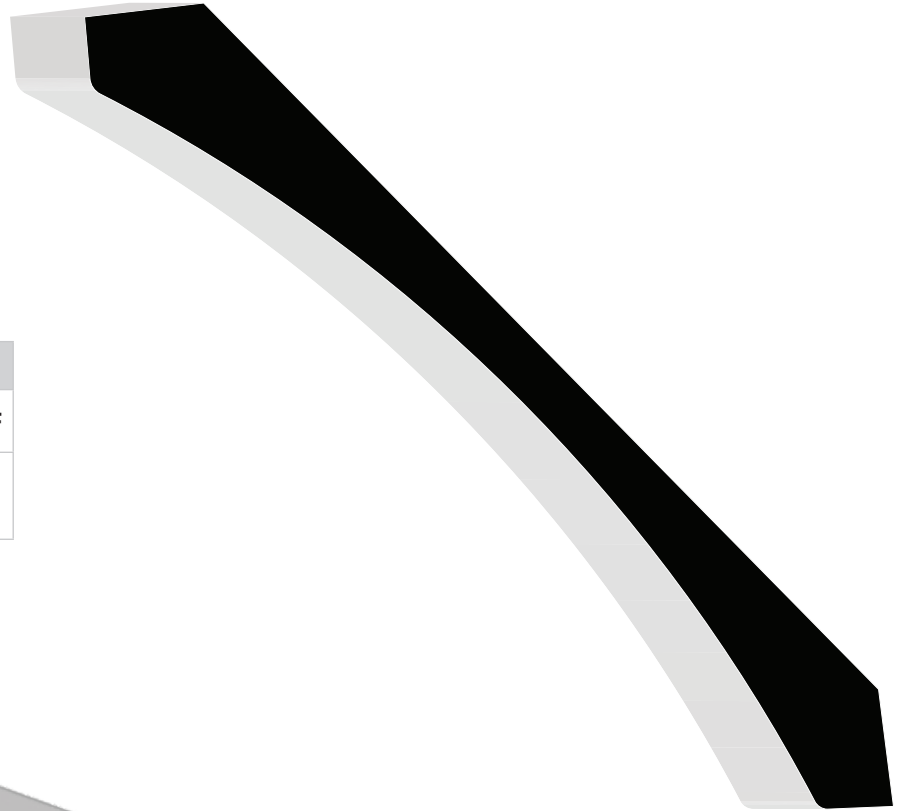

| SKU | Crown/Bed | |
|---|---|-----|
| 91168 | 9/16" x 5-1/4" | MDF |
|  | MDF Wall: 4-1/16" & Ceiling 3-1/4" | |

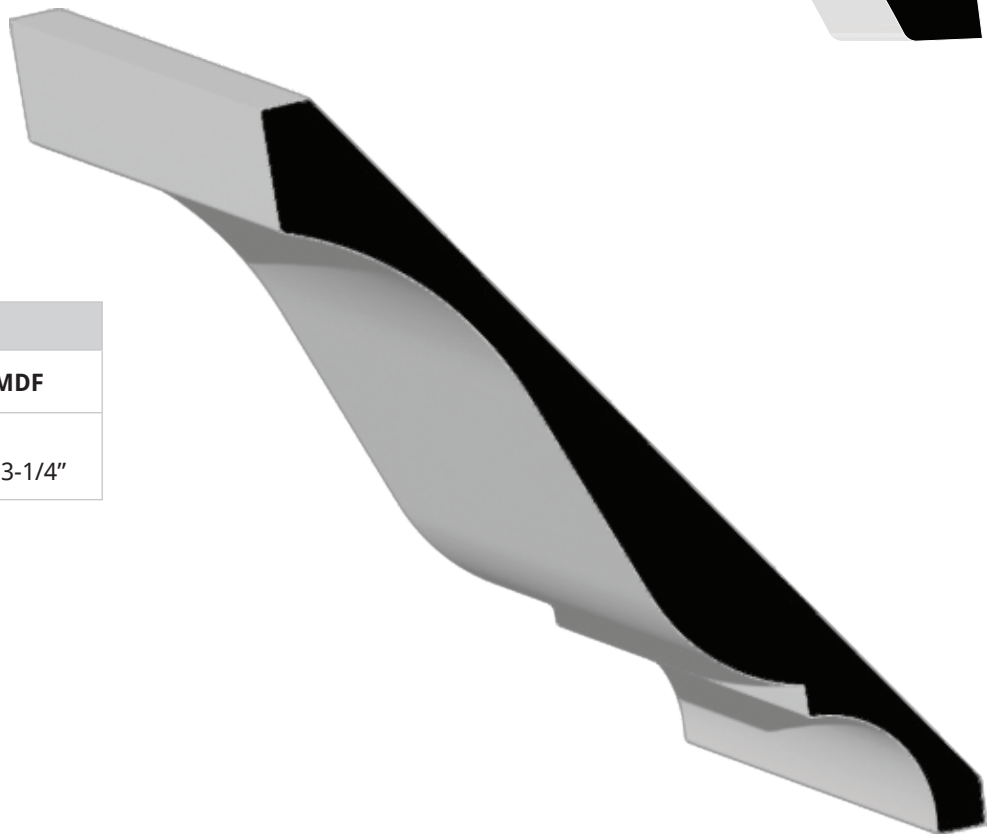

CEILING - CROWN/BED

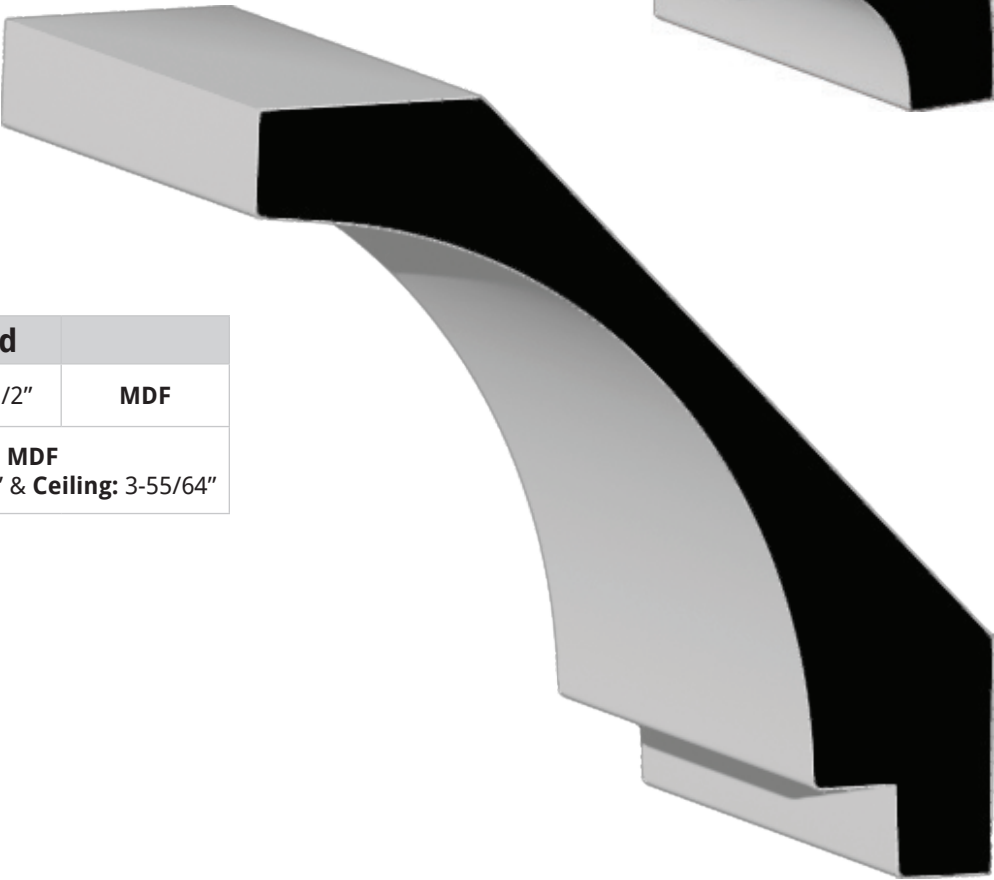
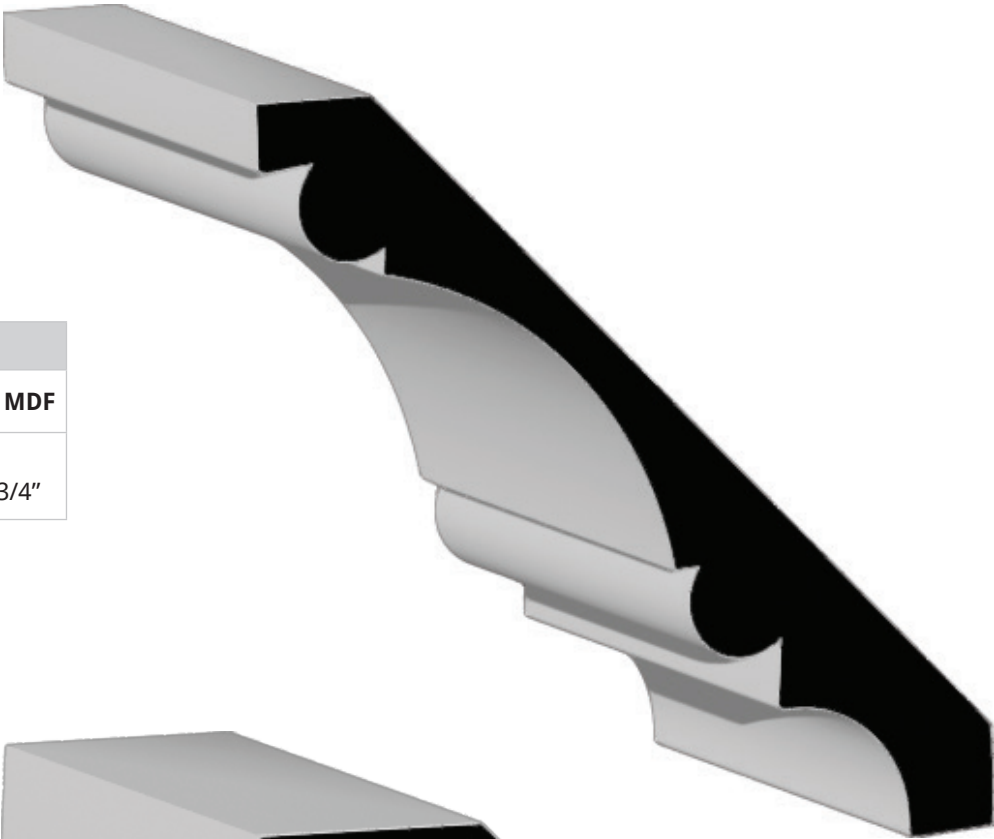

| SKU | Crown/Bed | |
|-----|--|-------------|
| 825 | 3/4" x 5-1/4" | Primed, MDF |
| | MDF Wall: 3-11/16" & Ceiling: 3-3/4" | |

| SKU | Crown/Bed | |
|-------|--|-----|
| 04153 | 1-3/16" x 5-1/2" | MDF |
| | MDF Wall: 3-29/32" & Ceiling: 3-55/64" | |

CEILING - CROWN/BED

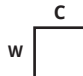
| SKU | Crown/Bed | |
|---|---|-----|
| 5096 | 1" x 7" | MDF |
|  | MDF Wall: 5-15/32" & Ceiling: 4-3/8" | |



| SKU | Crown/Bed | |
|---|--|-----|
| 4155 | 1-3/16" x 7-1/4" | MDF |
|  | MDF Wall: 5-5/32" & Ceiling 5-7/64" | |

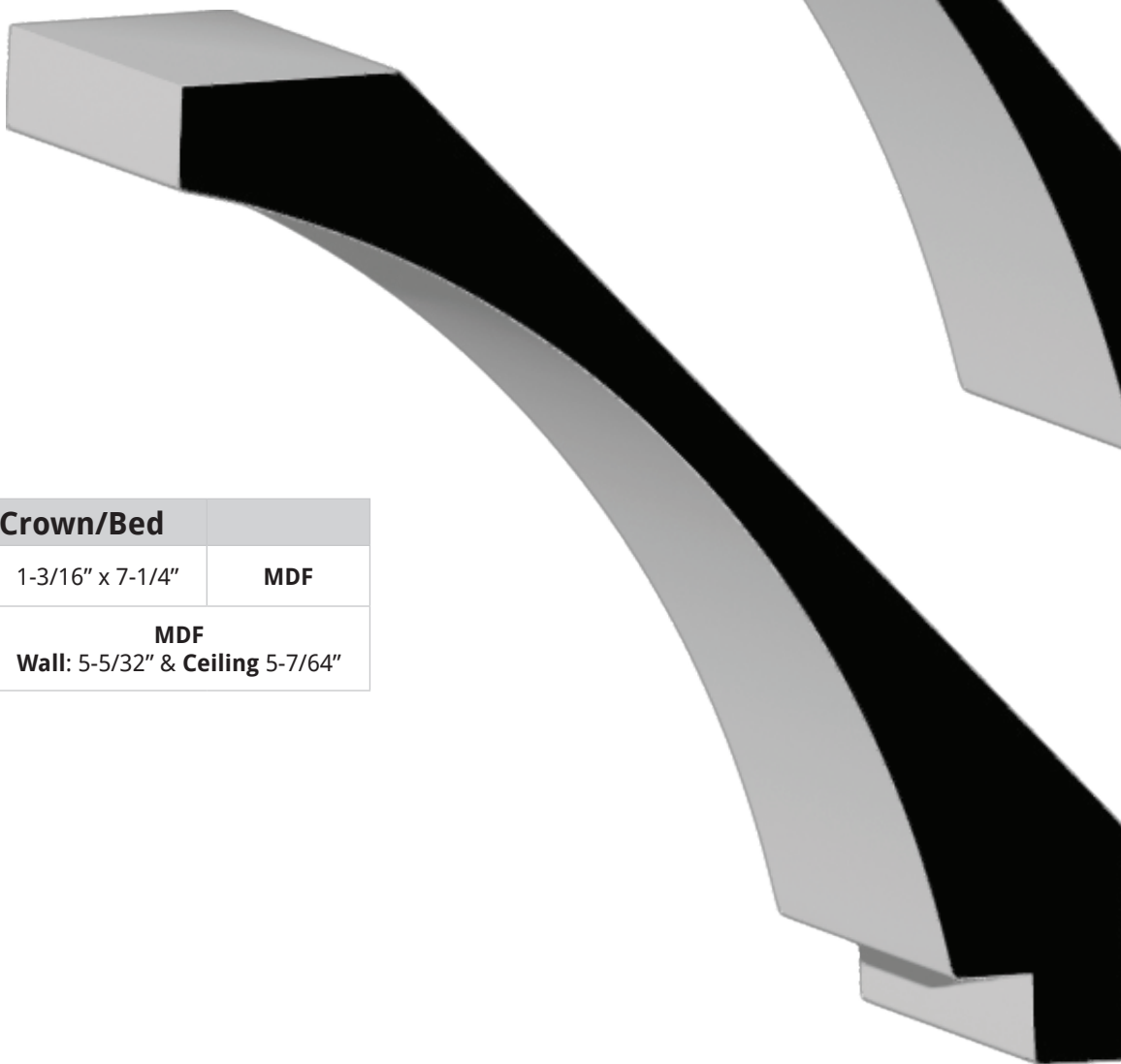

DOOR & WINDOW - CASING

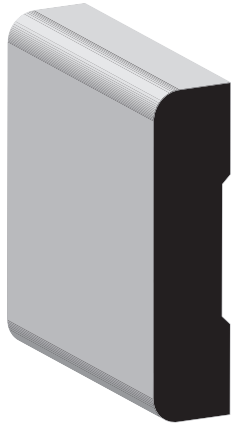

| SKU | Casing | |
|-----|----------------|--------|
| 473 | 9/16" X 2-1/4" | Primed |



| SKU | Casing | |
|-----|-----------------|--------|
| 453 | 11/16" X 2-1/4" | Primed |
| | 5/8" x 2-1/4" | MDF |

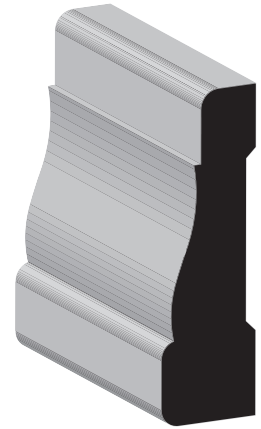

| SKU | Casing | |
|-----|-----------------|-------------|
| 356 | 11/16" X 2-1/4" | Primed, MDF |



| SKU | Casing | |
|-----------|---------------|--------|
| 472 (E2E) | 5/8" X 2-1/2" | MDF |
| | 9/16 X 2-1/2" | Primed |



| SKU | Casing | |
|-----|---------------|-------|
| 492 | 1/2" x 2-1/2" | Clear |

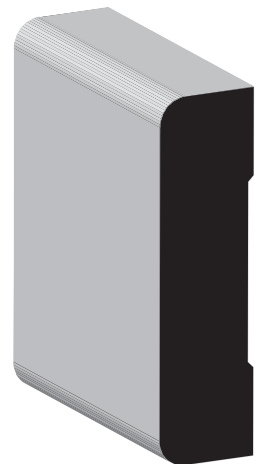

| SKU | Casing | |
|-----|-----------------|--------|
| 452 | 11/16" X 2-1/2" | Primed |

DOOR & WINDOW - CASING

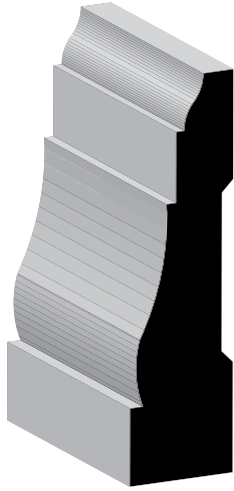

| SKU | Casing | |
|-----|-----------------|-------|
| 361 | 11/16" x 2-1/2" | Clear |



| SKU | Casing | |
|------|----------------|--------|
| 2488 | 9/16" X 2-3/4" | Primed |



| SKU | Casing | |
|-----|----------------|-------|
| 433 | 9/16" x 3-1/4" | Clear |

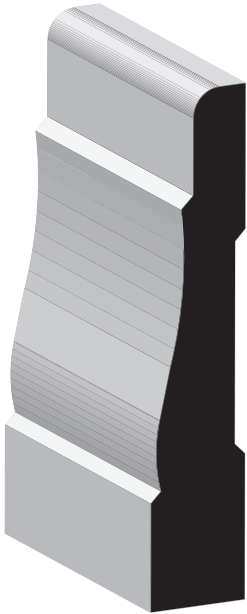

| SKU | Casing | |
|-----|-----------------|-------|
| 444 | 9/16" x 3-1/4" | MDF |
| | 11/16" x 3-1/2" | Clear |

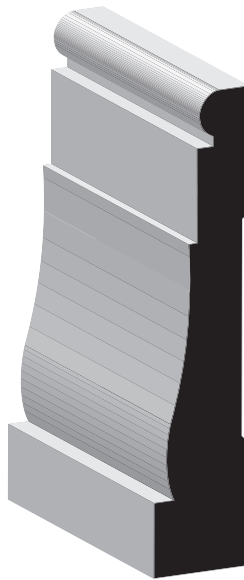

| SKU | Casing | |
|-----|-----------------|--------|
| 445 | 9/16" x 3-1/4" | MDF |
| | 11/16" x 3-1/4" | Primed |

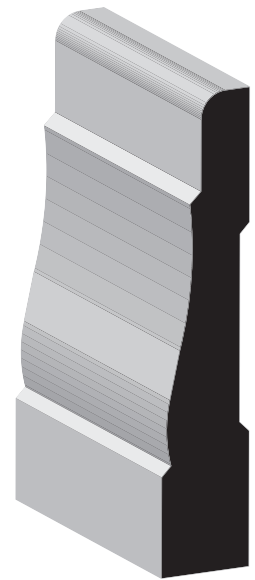

| SKU | Casing | |
|------|-----------------|---------------|
| L444 | 11/16" x 3-1/4" | Clear, Primed |

DOOR & WINDOW - CASING



| SKU | Casing | |
|------|---------------|-------------|
| L745 | 3/4" x 3-1/4" | Primed, MDF |



| SKU | Casing | |
|-------|---------------|----------------|
| 9091K | 5/8" x 3-1/2" | MDF, Primed FJ |



| SKU | Casing | |
|-----|----------------|--------------------|
| 432 | 9/16" X 3-1/2" | Clear, Primed, MDF |



| SKU | Casing | |
|-----|-----------------|-------------|
| 412 | 11/16" X 3-1/2" | Primed, MDF |

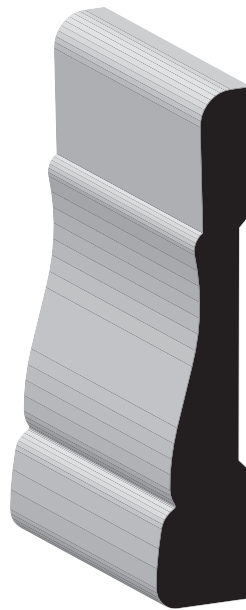

| SKU | Casing | |
|-----|-----------------|--------|
| 351 | 11/16" X 3-1/2" | Primed |



| SKU | Casing | |
|-----|-----------------|-------------|
| 719 | 11/16" x 3-1/2" | Primed, MDF |

DOOR & WINDOW - CASING



| SKU | Casing | |
|-------|------------------|--------------------|
| 91112 | 1 1/16" x 3-1/2" | Primed, FJ, MDF |

DOOR & WINDOW - BRICK MOULD & STOP

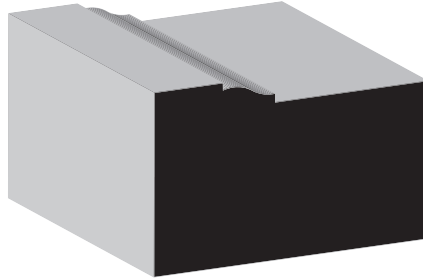

| SKU | Brick Mould | |
|-----|-------------|--------|
| 180 | 1-1/4" x 2" | Primed |

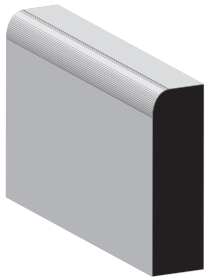

| SKU | Stop | |
|-----|---------------|--------|
| 887 | 3/8" x 1-1/4" | Primed |

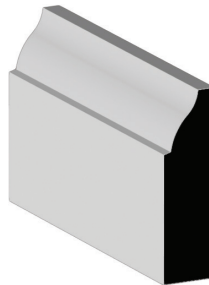

| SKU | Stop | |
|-----|---------------|--------|
| 947 | 3/8" x 1-1/4" | Primed |

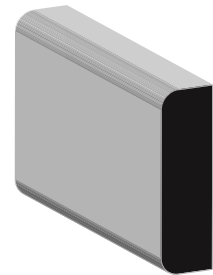

| SKU | Stop | |
|------|---------------|--------|
| L887 | 3/8" x 1-1/4" | Primed |



| SKU | Stop | |
|------|----------------|--------|
| L876 | 7/16" x 1-3/8" | Primed |

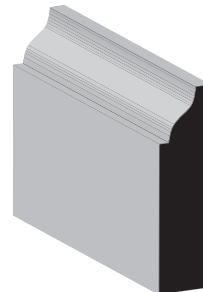

| SKU | Stop | |
|-----|----------------|-------------|
| 936 | 7/16" x 1-3/8" | Primed, MDF |

DOOR & WINDOW - JAMBS & STOOL

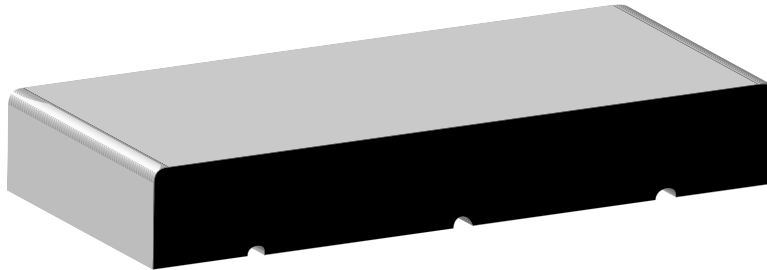

| SKU | Jambs | |
|---------------------|-------------------------|---------------|
| FLAT458P17 | 11/16 x 4-5/8 (no dado) | Primed |
| FLAT458PPID5 | 11/16 x 4-5/8 (6/8") | Primed |
| FLAT458P97D5 | 11/16 x 4-5/8 (8/0") | Primed |
| FLAT47868 | 11/16 x 4-5/8 (6/8") | Primed |
| FLAT51468 | 11/16 x 5-1/4 (6/8") | Primed |
| FLAT65868 | 11/16 x 6-5/8 (6/8") | Primed |
| FLAT65880 | 11/16 x 6-5/8 (8/0") | Primed |



| SKU | Stool | |
|--------------|-----------------|---------------|
| L1021 | 11/16" x 4-1/2" | Primed |
| | 11/16" x 5-1/4" | Primed |
| | 11/16" x 7-1/4" | Primed |

FLOOR - BASE

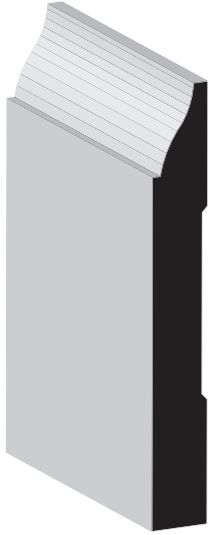

| SKU | Base | |
|-----|------------|--------------------|
| 634 | 7/16" x 3" | Clear, Primed, MDF |



| SKU | Base | |
|------|------------------|--------|
| 5093 | 1 1/32" X 3-1/4" | Primed |

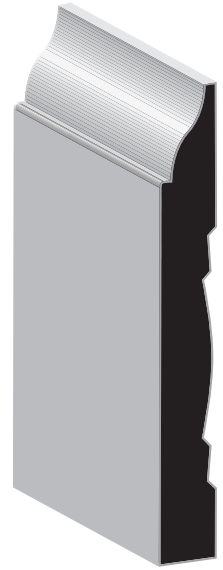

| SKU | Base | |
|-----|----------------|---------------|
| 633 | 7/16" x 3-1/4" | Clear, Primed |



| SKU | Base | |
|-----|----------------|---------------|
| 723 | 7/16" x 3-1/4" | Clear, Primed |

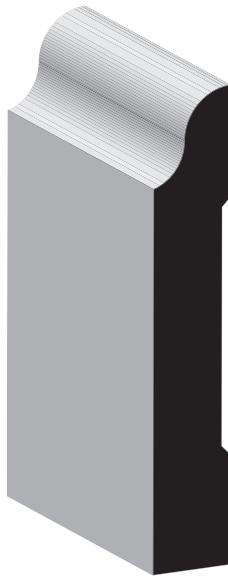

| SKU | Base | |
|-----|---------------|-------------|
| 663 | 1/2" x 3-1/4" | MDF, Primed |

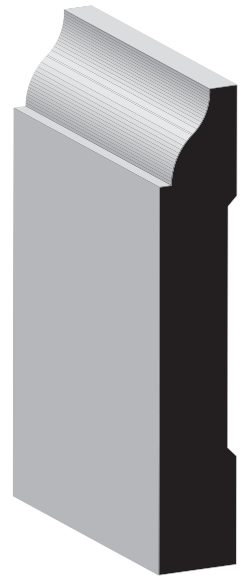

| SKU | Base | |
|-----|----------------|--------------------|
| 623 | 9/16" X 3-1/4" | Clear, Primed, MDF |

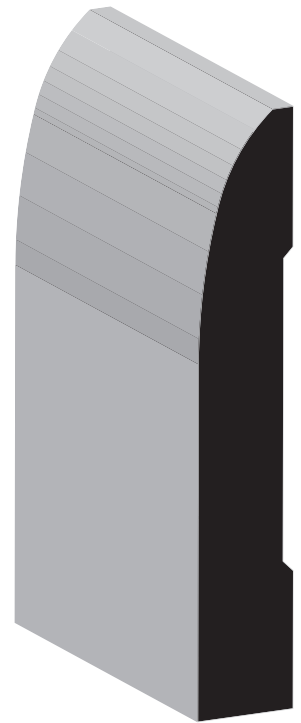

| SKU | Base | |
|------|----------------|--------|
| 430J | 7/16" X 4-1/4" | Primed |

| SKU | Base | |
|-----|----------------|-------------|
| 808 | 9/16" x 4-1/4" | Primed, MDF |

| SKU | Base | |
|-----|----------------|-------|
| 713 | 9/16" x 4-1/4" | Clear |

FLOOR - BASE



| SKU | Base | |
|-----|----------------|--------------------|
| 620 | 9/16" X 4-1/4" | Clear, Primed, MDF |



| SKU | Base | |
|-----|----------------|--------------------|
| 430 | 9/16" X 4-1/4" | Clear, Primed, MDF |



| SKU | Base | |
|-------|---------------|-----|
| 92133 | 1/2" x 5-1/4" | MDF |

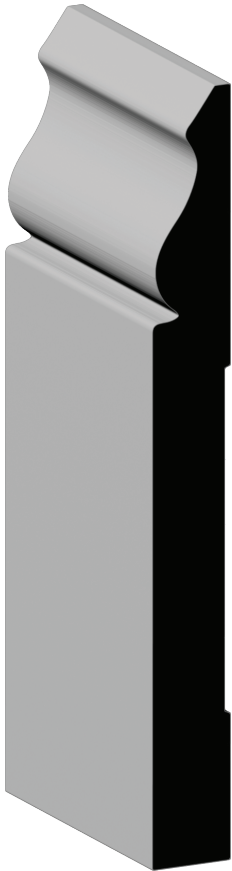

| SKU | Base | |
|-----|----------------|-------------|
| 163 | 9/16" x 5-1/4" | MDF, Primed |



| SKU | Base | |
|-----|----------------|--------|
| 818 | 9/16" X 5-1/4" | Primed |



| SKU | Base | |
|-----|----------------|--------|
| 618 | 9/16" X 5-1/4" | Primed |



| SKU | Base | |
|-------|----------------|--------|
| GM022 | 9/16" X 5-1/4" | Primed |



| SKU | Casing | |
|-------|---------------|----------------|
| 5204A | 1/2" X 5-1/4" | Primed, MDF |



| SKU | Base | |
|------|----------------|--------|
| 5095 | 7/16" x 5-1/4" | Primed |

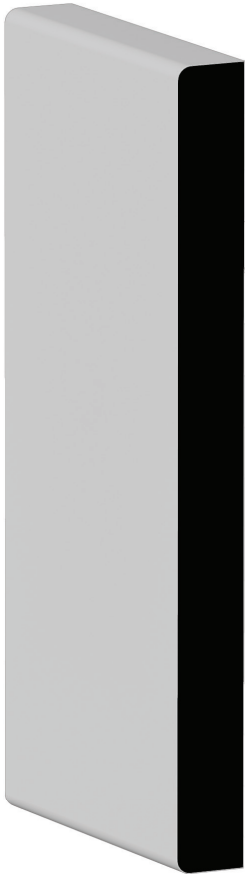

| SKU | Base | |
|-------|---------------|-----|
| 121X6 | 1/2" x 5-1/2" | MDF |



| SKU | Base | |
|-------|---------------|-----|
| 91232 | 5/8" x 7-1/4" | MDF |



| SKU | Base | |
|-------|---------------|----------------|
| 1342A | 1/2" x 7-1/4" | MDF, Primed |

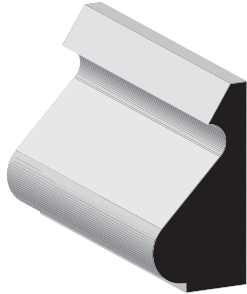

| SKU | Base Cap | |
|-----|------------------|-------------|
| 163 | 1 1/16" X 1-3/8" | Primed, MDF |

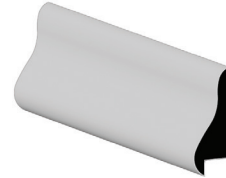

| SKU | Base Cap | |
|-----|---------------|--------|
| 400 | 5/8" X 1-3/4" | Primed |

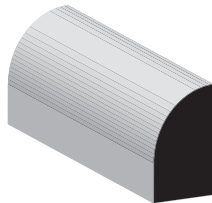

| SKU | Base Shoe | |
|-----|-------------|---------------|
| 126 | 1/2" x 3/4" | Primed, Clear |



| SKU | Base Shoe | |
|-----|--------------|--------|
| 129 | 7/16" x 3/4" | Primed |

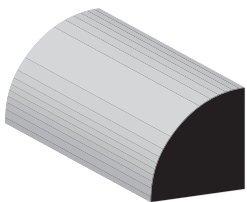

| SKU | Qtr Round | |
|-----|-------------------|--------|
| 106 | 1 1/16" x 1 1/16" | Primed |

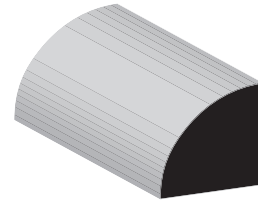

| SKU | Qtr Round | |
|-----|-------------|-------|
| 105 | 3/4" x 3/4" | Clear |

WALL - CHAIR RAIL & PANEL MOULD

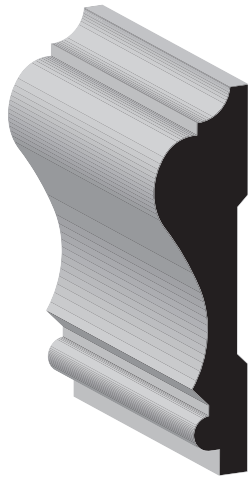

| SKU | Chair Rail | |
|-----|------------------|--------|
| 390 | 1 1/16" x 2-5/8" | Primed |

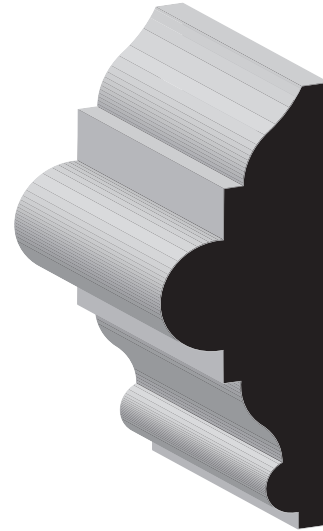

| SKU | Chair Rail | |
|-----|--------------|--------|
| 300 | 1-1/16" X 3" | Primed |

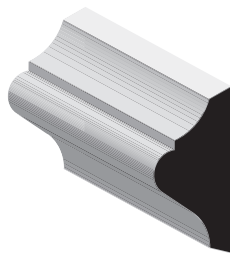

| SKU | Panel | |
|-----|----------------|--------|
| 183 | 9/16" X 1-1/8" | Primed |

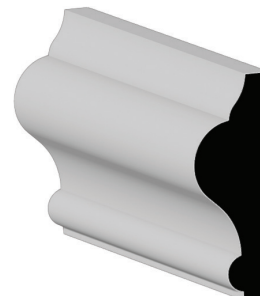

| SKU | Panel | |
|-----|----------------|--------|
| 185 | 9/16" X 1-1/2" | Primed |

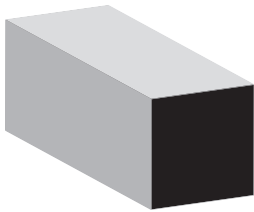

| SKU | Square | |
|-----|-------------|-------|
| 239 | 3/4" x 3/4" | Clear |



| SKU | Square | |
|-----|-----------------|--------|
| 248 | 11/16" x 1-3/4" | Clear |
| | 21/32" x 1-3/4" | Primed |

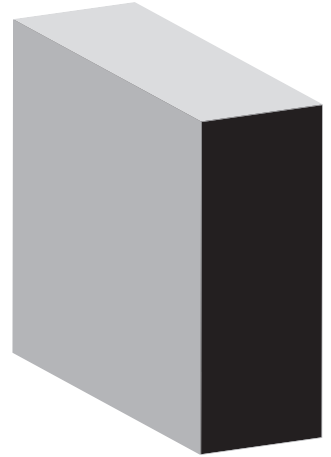

| SKU | Square | |
|-----|-----------------|-------|
| 246 | 11/16" x 2-3/4" | Clear |

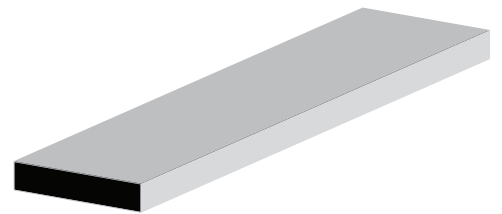
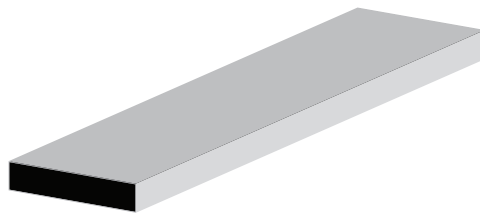
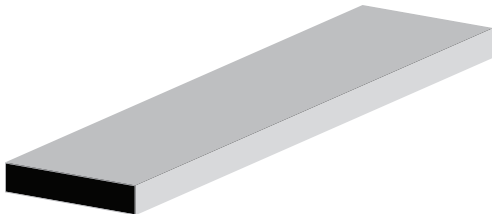

| Primed S4S Boards | | |
|---|---|--------|
| 23/32" S4S | 1 X 2 1 X 4 1 X 5 1 X 6 1 X 8 1 X 10 1 X 12 | Primed |
| 5/4 X 4 5/4 X 6 5/4 X 8 5/4 X 12 | | Primed |

| MDF S4S Boards | | |
|----------------|---|-----|
| 11/16" Thick | 1 X 4 1 X 6 1 X 8 1 X 10 1 X 12 | MDF |
| 11/16" E2E | 1 X 4 1 X 6 1 X 8 | MDF |

| Hardwood S4S Boards | | |
|---------------------|--|----------------|
| 3/4" | 1 X 2 1 X 4 1 X 6 1 X 8 1 X 12 | Oak and Poplar |



| SKU | Shiplap | |
|-----|---------------|--------|
| 231 | 5/8" x 5-1/2" | Primed |



| SKU | Shiplap | |
|-----|---------------|--------|
| 240 | 5/8" x 7-1/4" | Primed |

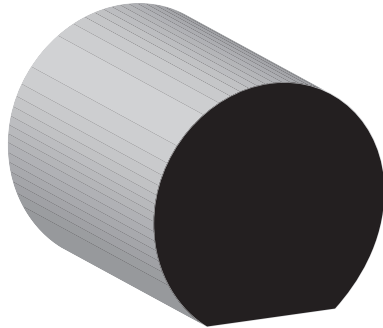

| SKU | Handrail | |
|-----|-------------------------|-------|
| 231 | 1-1/2" x 1-11/16" x 16' | Clear |

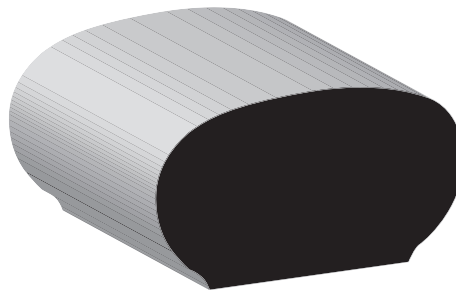

| SKU | Handrail | |
|-----|-----------------------|-------|
| 240 | 1-1/4" x 2-1/4" x 16' | Clear |



COLUMBUS DISTRIBUTION CENTER

6002 Sunnyside Road,
Indianapolis, IN 46236

Sales: (877) 880-9352
www.uslumber.com

IMAGES REPRESENT STANDARD PROFILES. ACTUAL PROFILES MAY VARY SLIGHTLY.